

Sportsman™ Mount

MOUNT YOUR GOPRO TO GUNS,
BOWS + FISHING RODS.

GoPro®
Be a *HERO*. ■■■■

/ What's Included

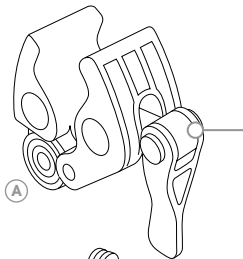

SPORTSMAN™ MOUNT

Fits 0.4"-0.9" (10mm to 23mm) diameter gun barrels, bow components and fishing rod grips.

Tightening Lever

Adjusts the width of the clamp to allow for various sizes and placements.



STRAIGHT EXTENSION ARM

Use when mounting to a bow or fishing rod grip.

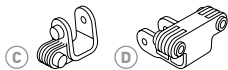

BRACKETS

Center and side brackets attach the camera housings and frames to the mount.

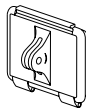

Dive Housing

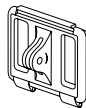

Standard Housing



DIVE + STANDARD HOUSING BACKDOOR MOUNTS*

Standard (waterproof) and Skeleton (not waterproof) Backdoor Mounts secure the housing to the mount and help stabilize the camera during recoil.

Note: Standard Housing Backdoor Mounts and the Standard Frame are not recommended for use with magnum or other high-recoil ammunition, such as turkey loads.

**For HERO4 Session, use the frames that came with your camera.*

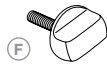

BRACKET SCREW

Secures the brackets to the mount.



THUMB SCREWS

Secure the straight extension arm and the camera housing or frame to the brackets.

/ Getting Started

TIGHTENING THE MOUNT

Turn the tightening lever to adjust the width of the clamp and secure it in place. When the clamp is tight, pivot the lever as desired.

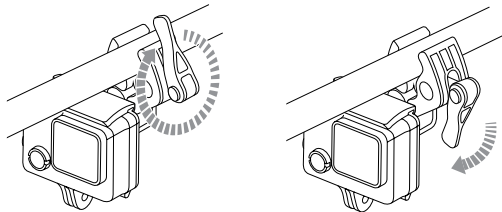

PRO TIP: To prevent damage when attaching the mount to fishing rods and wooden or carbon fiber bows, do not overtighten the mount.



WARNING

Visually check to make certain that your hunting equipment (including any firearm or bow of any kind) is not loaded before attaching, adjusting or removing the Sportsman Mount.

Never assume a firearm is unloaded.

Don't rely on your firearm's safety.

Always keep your firearm pointed in a safe direction and follow the firearm manufacturer's operating, servicing and safety instructions.

Do not use the Sportsman Mount if the barrel of the firearm is too hot to touch.

Mount users are solely responsible for safe use of their firearms. Do not use the mount in a manner that interferes with the operation of the trigger, safety or other mechanism of your firearm.

Comply with any state, local or record book regulations that restrict mounting any electronics, including cameras, to your hunting equipment.

/ Mounting Suggestions: Barrel

UNDER BARREL

To mount a camera under the barrel, use the center bracket. This bracket provides unobstructed operation of the firearm.

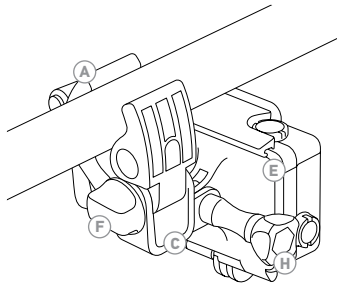

E BACKDOOR/FRAME

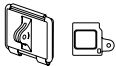

SIDE BARREL

To mount one or two cameras to the side of the barrel, use the side bracket. Capture footage looking forward (downrange), backward, or both directions simultaneously.

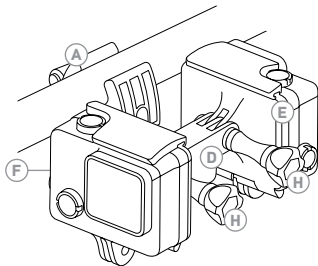

E BACKDOOR/FRAME

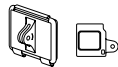

PRO TIP: Recoil might cause HERO4 Session to gradually move forward in the frame. Before reloading, be sure that the camera sits flush against the back of the frame to prevent it from falling out.

/ Mounting Suggestions: Bow

FORWARD

To capture the downrange POV, attach the mount to the riser, facing forward.

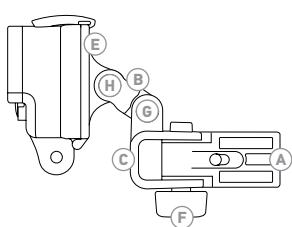

E BACKDOOR/FRAME

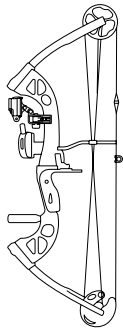

BACKWARD

To capture your stalk and the bow's draw and release, attach the mount to the top of the riser, angled down and backward.

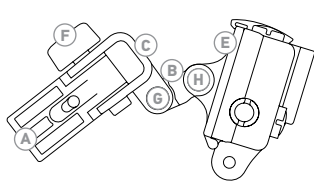

E BACKDOOR/FRAME

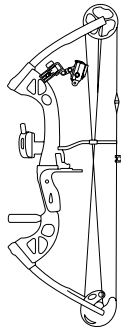

MOUNTING TO THE RISER

Risers offer several different mounting options, depending on the size, shape, and style of the bow. Choose placements that allow for the bow's natural motion, and avoid moving parts such as the limbs, cables, and cams.

Certain stabilizers are also compatible with the Sportsman Mount. Get creative—try different mounting positions to capture a variety of perspectives and angles, and see what works best for you.

PRO TIP: Use the GoPro App as a viewfinder to set up your shot and confirm your capture angle. Learn more at gopro.com.

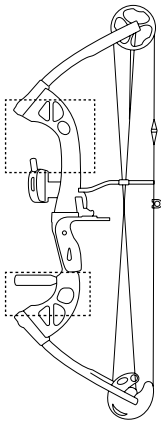

/ Mounting Suggestions: Rod

Always mount to the grip, not the blank.

FORWARD

To capture a down-the-rod point of view, use the center bracket. Mount it to the grip on the side opposite the reel, so the line and reel remain unimpeded.

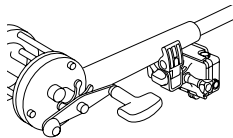
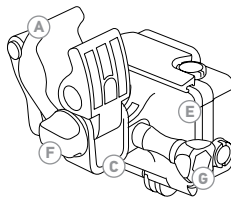

E BACKDOOR/FRAME



BACKWARD

To look back at the angler, use the side bracket and straight extension arm. Mount it on the grip just forward of the reel, with the camera facing backwards.

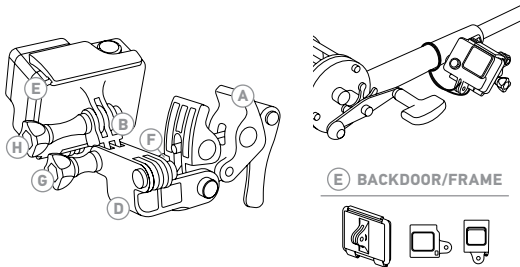

PRO TIPS:

Audio Capture: For enhanced audio in dry, dust-free environments, use the Skeleton Backdoor Mount or a frame.

Camera Control: For cameras other than HERO4 Session, turn on One Button mode or QuikCapture to simplify camera operations when using the Sportsman Mount.

Barrel Mounting: Be sure to tighten the clamp securely to the barrel to prevent it from slipping during recoil. In addition, use a screwdriver or The Tool to tighten the thumb screw to prevent the camera angle from shifting during recoil.

Fishing: To help prevent losing your camera while fishing, tether the camera housing, frame, or the mount itself to your rod using high test fishing line or a GoPro Camera Tether.

Hunting: For optimal use during hunting, turn off the camera's LED lights and sound indicator in Setup or Settings mode.

CUSTOMER SUPPORT

GoPro is dedicated to providing the best possible service. To reach GoPro Customer Support, visit gopro.com/support.

Learn more about GoPro
products at **gopro.com**



Please Recycle

130-13431-000 REVA